

Legend

	Proposed Deciduous Tree		Tree Protection Fencing		Proposed Bike Ring
	Proposed Coniferous Tree		Prop. 1.8m HT Wood Privacy Screen Typ.		Proposed Decorative Entry Feature Wall
	Existing Deciduous Tree Canopy		Prop. 2.3m HT Wood Acoustic Fence Typ.		Proposed Bench
	Existing Coniferous Tree Canopy		Prop. 1.2 Ornamental Metal Fence		Detail Reference Key
	Tree Protection Zone (TPZ)		Property Line		Plant Material Reference Key
			Proposed Curb Typ.		
			Prop. Sodded Area Typ.		
			Prop. Concrete Paving Typ.		

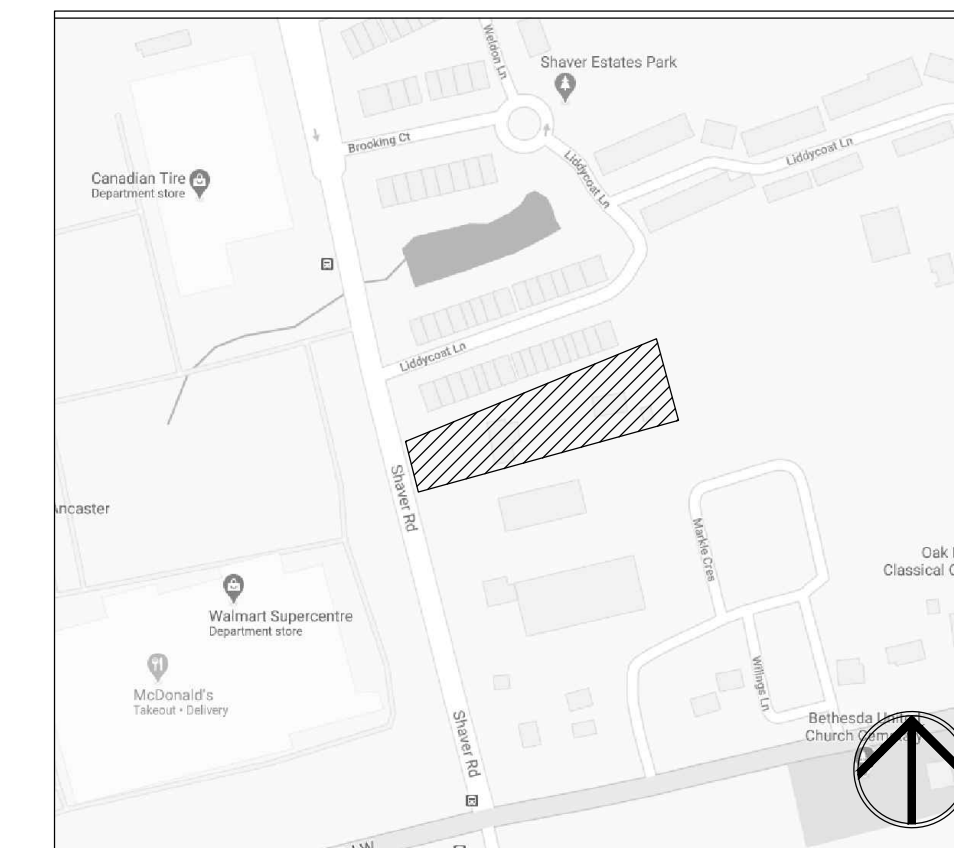

Key Map

msla
MARTON SMITH LANDSCAPE ARCHITECTS
 170 The Donway W Suite 206,
 Toronto, Ontario, Canada. M3C 2G3
 tel. 416.492.9966 | email. info@msla.ca

Architect:
 Client/Owner:



Municipality:

Notes:

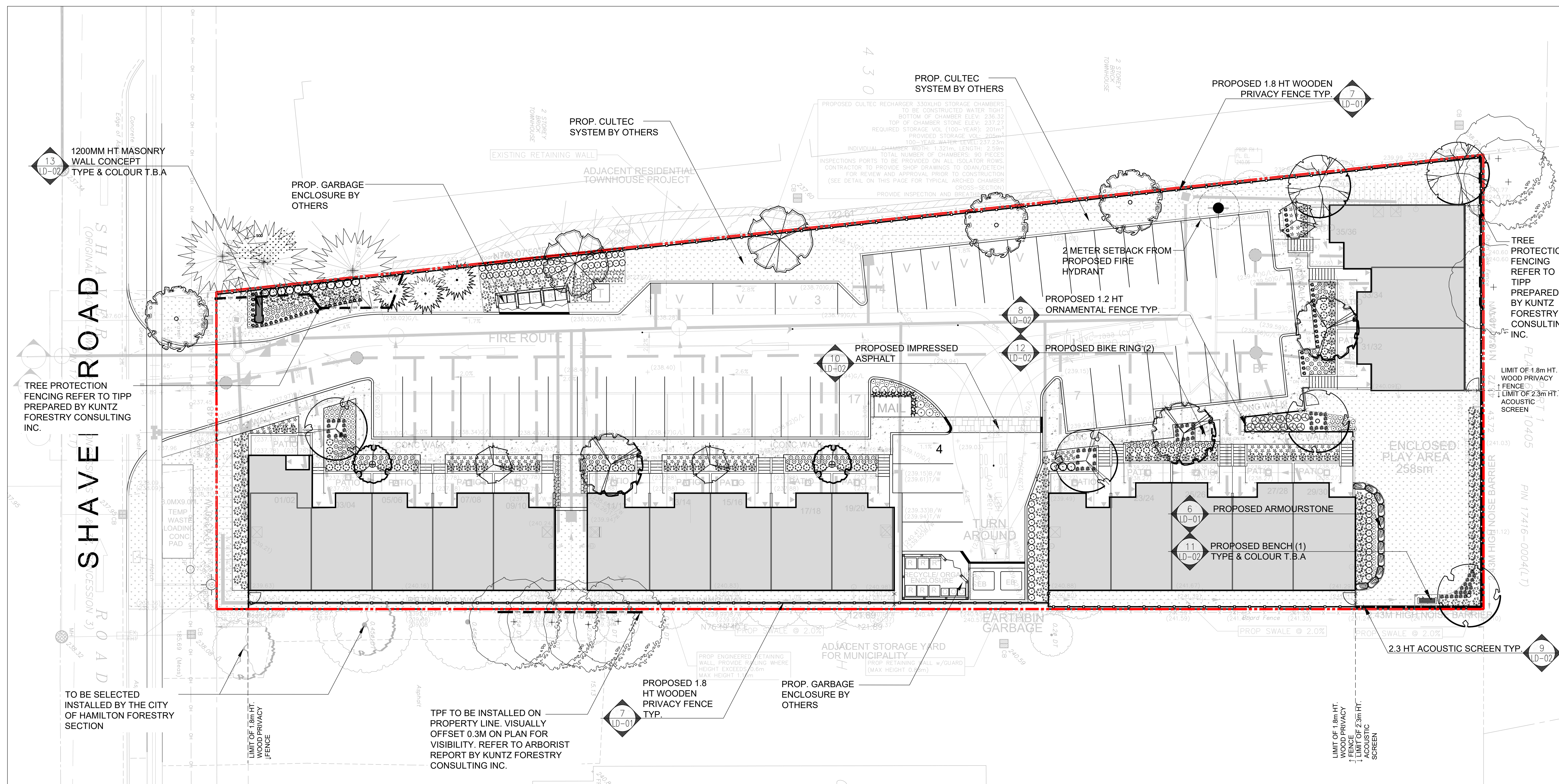

05	Issued for Resubmission	11/30/22
04	Issued for Resubmission	11/01/22
03	Issued for Submission	08/24/22
02	Issued for Review	08/10/22
01	Issued for Review	05/21/21
No.	Revision	Date

North:

Stamp:

Project:
Proposed Stacked Townhouse Development
 487 Shaver Rd,
 Ancaster, Ontario

Scale: **1:200** Date: **Apr 2021**
 Drawn By: **C.F.** Checked By: **L.M.**

Drawing Title:
Landscape Plan

Project No. **21101** Sheet No. **L1-01**

All information contained in these plans shall be checked by the contractor. All discrepancies shall be reported to the Landscape Architect. Copying or any reproduction in part or whole that is not permitted without the consent of L.A. A drawing shall not be used for construction unless sealed & SIGNED.
 NOTE FOR ANY AND ALL GRADING INFORMATION REFER TO SITE GRADING ENGINEERING DRAWINGS. NO SLOPES ARE TO EXCEED 3:1. PROPERTY LINES AND SETBACKS MUST BE COVERED BY CONTRACTOR PRIOR TO CONSTRUCTION. ANY AND ALL RETAINING WALLS MUST BE APPROVED BY STRUCTURAL ENGINEER PRIOR TO CONSTRUCTION.
 DO NOT SCALE DRAWINGS • PRELIMINARY NOT FOR CONSTRUCTION • THESE DRAWINGS ARE NOT TO BE USED FOR CONSTRUCTION UNTIL COUNTERSIGNED BY L. ARCHITECT • SIGNED DATE

Legend

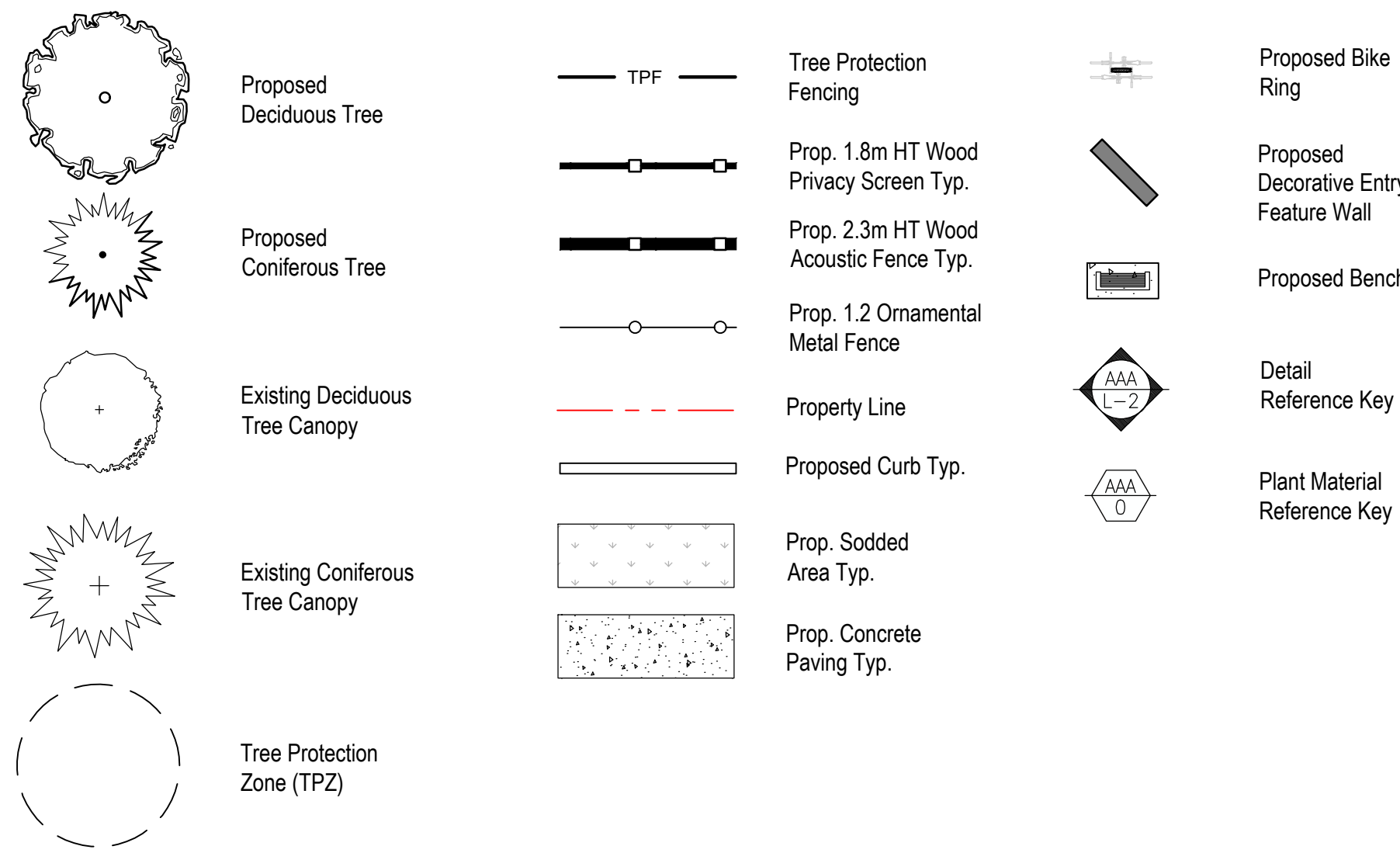

Proposed Plant Material List

KEY	QNTY	BOTANICAL NAME	COMMON NAME	HT/CAL	SPREAD	ROOT	DROUGHT TOLERANT	NATIVE	REMARKS
DECIDUOUS TREES									
ASA	2	<i>Acer saccharinum</i>	Silver Maple	70 mm		B.&B.	High	Yes	Full Form
AXF	2	<i>Acer x freemanii</i> 'Jeffersred'	Jeffersred Freeman Maple	70 mm		B.&B.	High	Yes	Full Form
GSS	3	<i>Quercus triacanthos</i> 'Shademaster'	Shademaster Honey-Locust	70 mm		B.&B.	High	No	Full Form
ORB	2	<i>Quercus rubra</i>	Red Oak	70 mm		B.&B.	High	Yes	Full Form
TAM	3	<i>Tilia Americana</i>	Basswood Linden	70 mm		B.&B.	High	Yes	Full Form
SPECIMEN									
AAD	2	<i>Amelanchier arborea</i>	Downy Serviceberry (Tree Form)	50 mm		B.&B.	High	Yes	Tree Form
CCA	4	<i>Cercis canadensis</i> 'Multi Stem'	Eastern Red Bud	180 cm	pink/pur	B.&B.	High	Yes	Tree Form
PRJ	2	<i>Prunus serrulata</i> 'Amanogawa'	Japanese Flowering Cherry	45 mm		W.B.	MED	No	Full Form (Columnar)
CONIFEROUS TREES									
PGL	3	<i>Picea glauca</i>	White Spruce	200 cm		B.&B.	High	Yes	Full Form
DECIDUOUS SHRUBS									
VTC	15	<i>Viburnum trilobum</i> 'Compactum'	Compact High Bush-Cranberry	70 cm		C.G.	High	Yes	Full Form
CNK	14	<i>Cornus sericea</i> 'Keleysi'	Keleysi Red Osier Dogwood	60 cm		C.G.	High	Yes	Full Form
HPB	37	<i>Hydrangea paniculata</i> 'Bombshell'	Dwarf Bombshell Hydrangeas	60 cm	5 gal.	C.G.	High	No	Full Form
VLE	73	<i>Viburnum lentago</i>	Nannyberry	80 cm		C.G.	High	Yes	Full Form
SMP	7	<i>Syringa meyeri</i> 'Palibin'	Purple Dwarf Korean Lilac	60 cm		C.G.	High	No	Full Form
CONIFEROUS SHRUBS									
TCF	143	<i>Taxus cuspidata</i> 'Fairview'	Fairview Yew	65 cm		C.G.	MED	No	Full Form
TMH	68	<i>Taxus media</i> 'Hill'	Hill's Yew	70 cm		C.G.	MED	No	Full Form
PERENNIALS									
HJS	166	<i>Hemerocallis</i> 'Joan Senior'	Joan Senior (white) Daylilies	2 Gal.			Yes	No	Full Form
GER	89	<i>Geranium maculatum</i>	Wild Geranium	2 Gal.			High	Yes	Full Form (PPOY Winner)
SAM	125	<i>Salvia x sylvestris</i> 'May Night'	May Night Salvia	2 Gal.			High	No	Full Form - Purple Flowers (PPOY Winner)
GRASSES									
CAC	32	<i>Calamagrostis acutiflora</i> 'Karl Foerster'	Karl Foerster Feather Reed Grass	5 Gal.			High	No	Full Form (PPOY Winner)
PVN	53	<i>Panicum virgatum</i> 'Northwind'	Northwind Switch Grass	2 Gal.			High	Yes	Full Form
PAB	66	<i>Pennisetum alopecuroides</i> 'Little Bunny'	Little Bunny Dwarf Fountain Grass	2 Gal.			High	No	Full Form

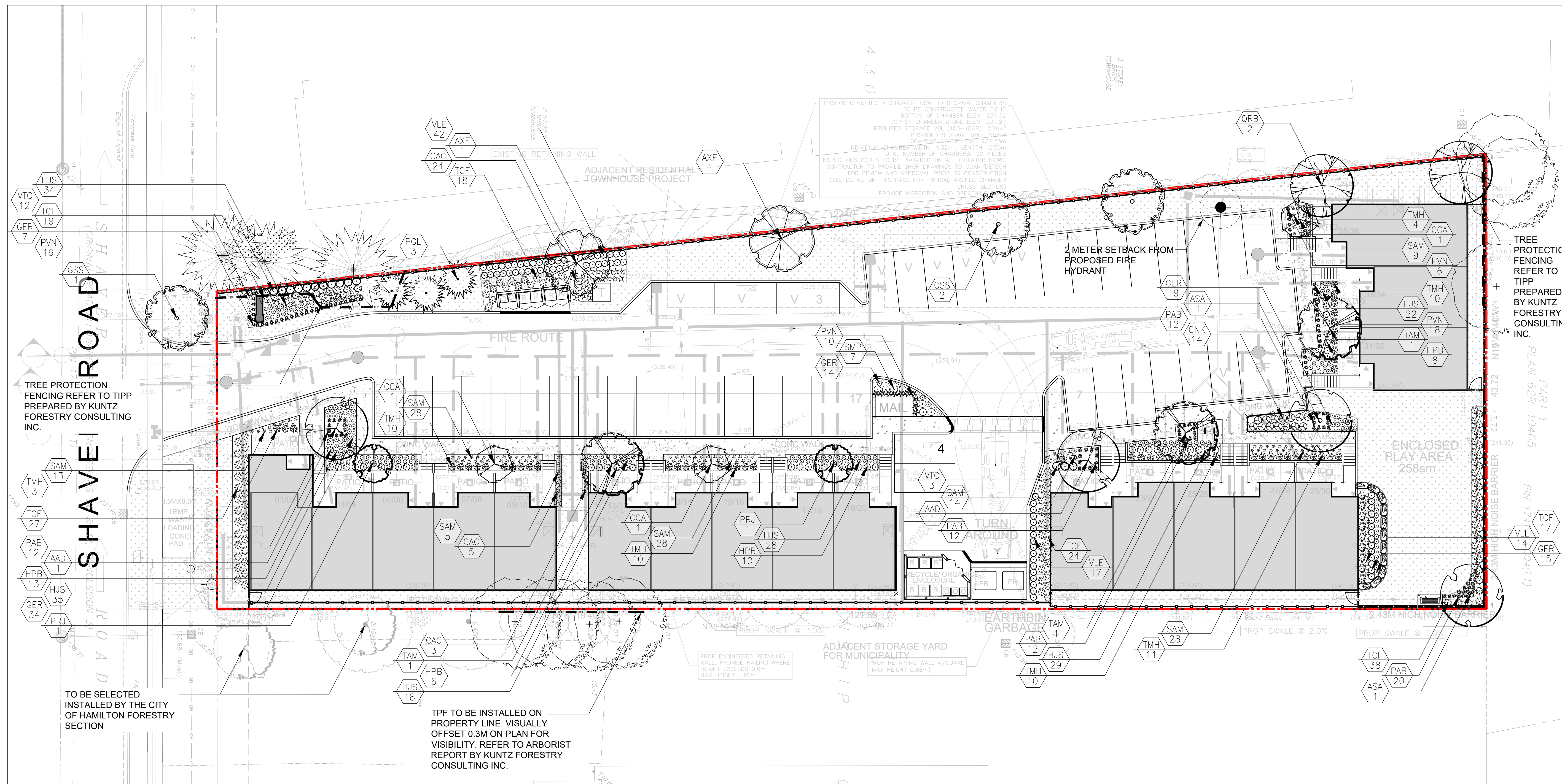

05	Issued for Resubmission	11/30/22
04	Issued for Resubmission	11/01/22
03	Issued for Submission	08/24/22
02	Issued for Review	08/10/22
01	Issued for Review	05/21/21
No.	Revision	Date

North:

Stamp:

Project:
Proposed Stacked Townhouse Development
 487 Shaver Rd,
 Ancaster, Ontario

Scale: **1:200** Date: **Apr 2021**
 Drawn By: **C.F.** Checked By: **L.M.**

Drawing Title:
Landscape Planting Plan

Project No. **21101** Sheet No. **L1-02**

All information contained in these plans shall be checked by the contractor. All dimensions shall be reported to the Landscape Architect. All before construction. All drawings have copyright and shall remain the property of the Landscape Architect. Copying or any reproduction in part or whole that only be permitted with written consent of L.A. Drawings shall not be used for construction unless marked & SIGNED.
 NOTE FOR ANY AND ALL GRADING INFORMATION REFER TO SITE GRADING ENGINEERING DRAWINGS. NO SLOPES ARE TO EXCEED 3:1. PROPERTY LINES AND SETBACKS MUST BE CONFORMED BY CONTRACTOR PRIOR TO CONSTRUCTION. ANY AND ALL RETAINING WALLS MUST BE APPROVED BY STRUCTURAL ENGINEER PRIOR TO CONSTRUCTION.
 DO NOT SCALE DRAWINGS • PRELIMINARY NOT FOR CONSTRUCTION UNTIL COUNTERSIGNED BY L.A. ARCHITECT • SIGNED DATE

Proposed Soil Volume Chart

Soil Area	Soil Area (m ²)	Soil Depth (m)*	Soil Volume (m ³)	Tree Quantity	Soil Volume per tree (m ³)
1	24.02	0.9	21.6	1	21.6
2	24.08	0.9	21.7	1	21.7
3	24.01	0.9	21.6	1	21.6
4	20.8	1.2	25.0	1	25.0
5	18.14	1.2	21.8	1	21.8
6	29.88	0.9	26.9	1	26.9
7	22.33	1.2	26.8	1	26.8
8	24.17	0.9	21.8	1	21.8
9	24.19	0.9	21.8	1	21.8
10	24.17	0.9	21.8	1	21.8
11	24.17	0.9	21.8	1	21.8
12	24.42	0.9	22.0	1	22.0
13	24.84	0.9	22.4	1	22.4
14	24.23	0.9	21.8	1	21.8
Totals	333.45		318.49	14	

Legend

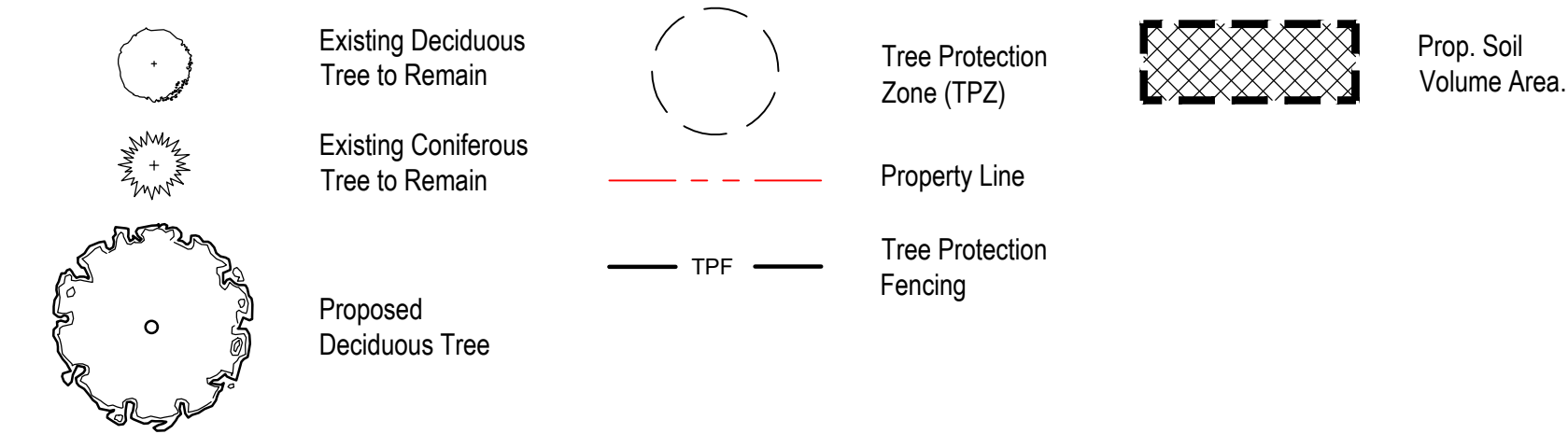

Architect:

Client/Owner:

Municipality:



Notes:

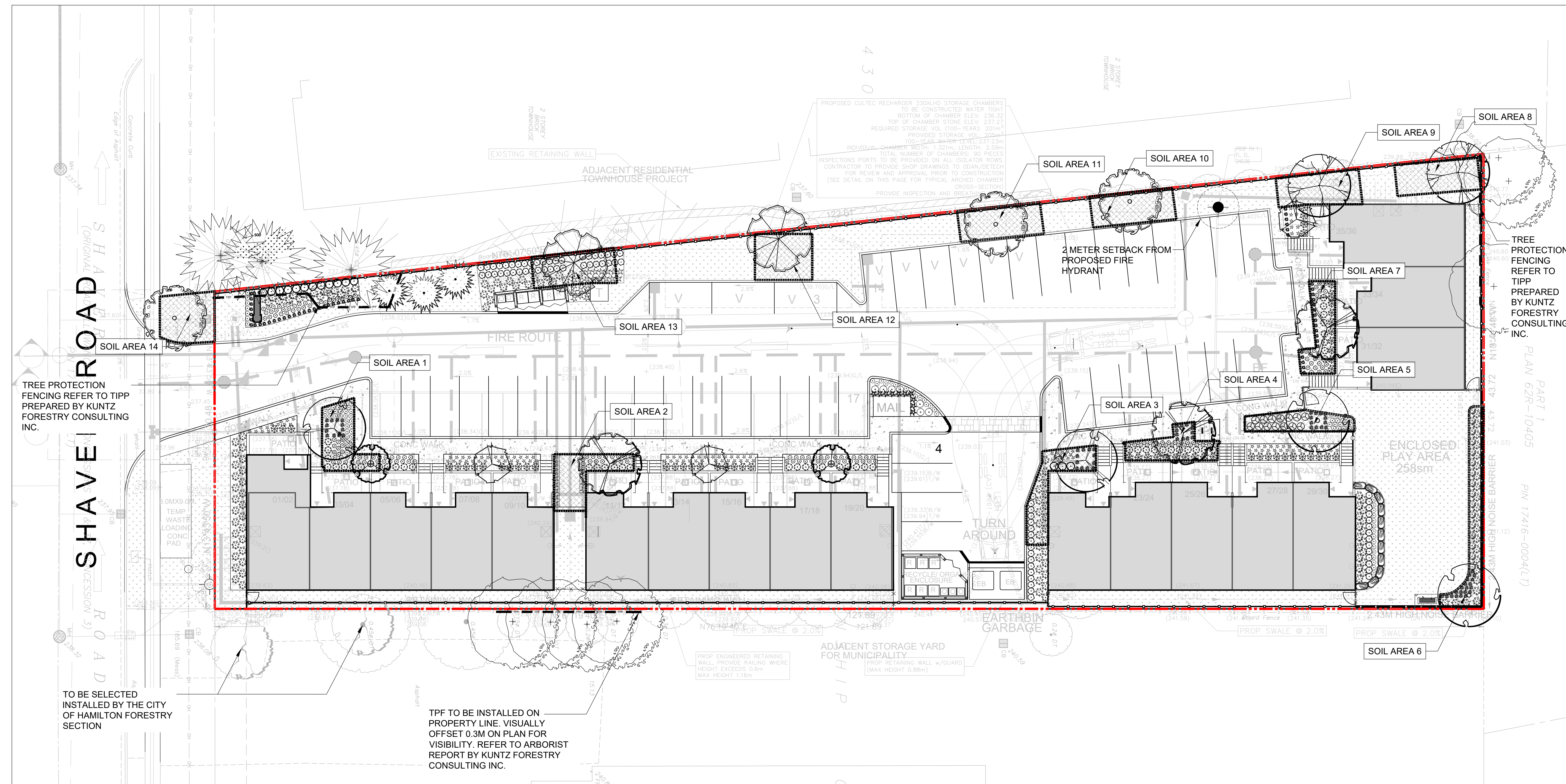

05	Issued for Resubmission	11/30/22
04	Issued for Resubmission	11/01/22
03	Issued for Submission	08/24/22
02	Issued for Review	08/10/22
01	Issued for Review	05/21/21
No.	Revision	Date

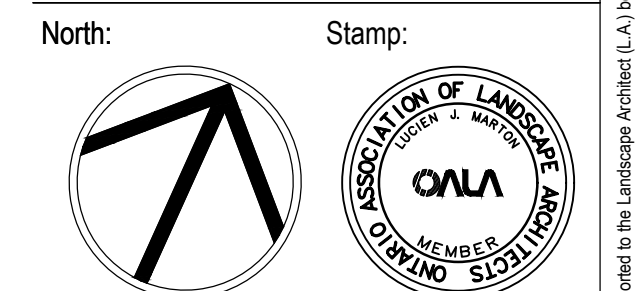

Project:
Proposed Stacked Townhouse Development
 487 Shaver Rd,
 Ancaster, Ontario

Scale: **1:200** Date: **Apr 2021**

Drawn By: **C.F.** Checked By: **L.M.**

Drawing Title:
Landscape Soil Volume Plan

Project No. **21101** Sheet No. **L1-03**

All information contained in these plans shall be checked by the contractor. All dimensions shall be reported to the Landscape Architect. All before commencing with construction. All drawings have copyright and shall remain the property of the Landscape Architect. Copying or any reproduction in part or whole shall only be permitted with written consent of L.A. A drawing shall not be used for construction unless marked & SIGNED.
 NOTE: FOR ANY AND ALL GRADING INFORMATION REFER TO SITE GRADING ENGINEERING DRAWINGS. NO SLOPES ARE TO EXCEED 3:1. PROPERTY LINES AND SETBACKS MUST BE COVERED BY CONTRACTOR PRIOR TO CONSTRUCTION. ANY AND ALL RETAINING WALLS MUST BE APPROVED BY STRUCTURAL ENGINEER PRIOR TO CONSTRUCTION.
 DO NOT SCALE DRAWINGS • PRELIMINARY NOT FOR CONSTRUCTION • THESE DRAWINGS ARE NOT TO BE USED FOR CONSTRUCTION UNTIL COUNTERSIGNED BY L.A. ARCHITECT • SIGNED _____ DATE _____

REFER TO PLAN FOR LOCATION

LANDSCAPE SPECIFICATIONS

CONTRACTOR MUST CONTACT ALL UTILITY COMPANIES FOR STAKE OUTS PRIOR TO ANY EXCAVATION OR PLANTING.

ROUGH GRADING

ROUGH GRADE AND FILL AREAS TO ESTABLISH SUBGRADE AS REQUIRED. PROVIDE DRAINAGE PATTERN AS INDICATED ON DRAWINGS. ROUND SMOOTHLY ALL TOPS AND TOES OF SLOPES. COMPACT ALL AREAS TO 90% STANDARD PROCTOR DENSITY UNLESS SPECIFIED OTHERWISE. EXISTING TREES TO REMAIN ON SITE ARE TO BE PROTECTED AS DETAILED.

FINE GRADING

FINE GRADE ALL AREAS TO FINISHED GRADES AS SHOWN ON LAYOUT OR GRADING PLAN OR ARCHITECT'S SITE PLAN. PROVIDE UNIFORM SLOPES AWAY FROM THE BUILDING, UNLESS SPECIFIED OTHERWISE. SLOPES MAY NOT EXCEED 33:10% (3:1).

SPREADING OF TOPSOIL

SCARIFY THE SUBSOIL PRIOR TO THE SPREADING THE TOPSOIL. REMOVE ALL DEBRIS AND LEAVE A FINE-TEXTURED EVEN SURFACE. ALL TOPSOIL TO BE IMPORTED UNLESS PREVIOUSLY APPROVED BY LANDSCAPE ARCHITECT. OBTAIN APPROVAL FOR THE QUALITY OF ANY IMPORTED TOPSOIL BEFORE DELIVERY TO THE SITE. TOPSOIL IS TO BE COMPACTED TO CREATE A FIRM AND EVEN SURFACE.

SOD

USE NO. 1 TURF GRASS NURSERY SOD WHICH CONFORMS WITH THE SPECIFICATIONS OF THE NURSERY SOD GROWERS ASSOCIATION OF ONTARIO. ALL LAWN AREAS SHALL RECEIVE A MINIMUM OF 100MM (4") OF COMPACTED TOPSOIL, AND SHALL BE SODDED WITH #1 KENTUCKY BLUEGRASS - FESCUE. NO SOD SLOPES ARE TO EXCEED 3:1. SLOPE IN EXCESS OF 4:1 TO BE FEGED.

MINERAL FERTILIZER

APPLY THE FOLLOWING MINERAL FERTILIZER UNLESS SOILS TESTS SHOW OTHER REQUIREMENTS:

- SODDED AREAS - 11% NITROGEN, 8% PHOSPHORUS AND 4% POTASH (11-8-4) AT THE RATE OF 4.5 KG OVER M2 (10 LBS OVER 1000 SQ. FT.).
- PLANTING BEDS - 7% NITROGEN, 7% PHOSPHORUS AND 7% POTASH (7-7-7) AT THE RATE OF 40 GRAMS (1 OZ.) FOR EVERY BUSHEL OF TOPSOIL.

PREPARATION OF PLANTING BEDS

ALL PLANT BEDS TO BE CONTINUOUS. EXCAVATE ALL PLANTING BEDS TO THE DEPTH AS INDICATED ON THE DRAWINGS AND DETAILS. MIN 450mm (18"). BACKFILL ALL PLANTING BEDS WITH A SOIL MIXTURE CONSISTING OF SIX (6) PARTS OF SAND/LOAM, ONE (1) PART OF FINELY PULVERIZED PEAT MOSS, TWO (2) PARTS OF WELL-ROTTED MANURE AND THE MINERAL FERTILIZER AS SPECIFIED ABOVE. ALSO ADD 30 KILOGRAMS (66 LBS) PER CUBIC METER OF PLANTING SOIL (1 LB. CUBIC YARD). PREPARE THE PLANTING BEDS FOR PLANTING BEFORE THE DELIVERY OF THE PLANT MATERIAL TO THE JOB SITE.

NOTE: IF THE EXISTING SOIL CONDITIONS ARE CLAY OR WET IN NATURE, CONTACT THE LANDSCAPE ARCHITECT FOR INSTRUCTIONS OF A SUITABLE SOIL MIXTURE. FAILURE TO DO THIS MAY RESULT IN DELAY OF APPROVAL AND ACCEPTANCE.

PLANT MATERIALS

ALL PLANT MATERIAL SHALL CONFORM TO THE STANDARDS OF THE CANADIAN NURSERY TRADES ASSOCIATION FOR SIZE AND SPECIES.

ALL SHRUB AND TREE MATERIAL SHALL BE CONTAINER GROWN, POTTED, S/B OR B/B, UNLESS OTHERWISE NOTED. BARE ROOT PLANTING SHALL BE ACCEPTABLE FOR CERTAIN SPECIES DURING EARLY SPRING OR LATE FALL PLANTING SEASON. CONTRACTOR SHALL MAKE REQUESTS FOR ROOT CONDITION SUBSTITUTION IN WRITING TO THE LANDSCAPE ARCHITECT PRIOR TO COMMENCEMENT OF PLANTING OPERATIONS. ALL PLANT MATERIAL IS TO BE CLAY GROWN STOCK UNLESS OTHERWISE NOTED.

LANDSCAPE SPECIFICATIONS

SCALE: N.T.S. DATE: 1 LD-01

REFER TO PLAN FOR LOCATION

PLANT MATERIAL INSTALLATION

ALL TREES, SHRUBS AND GROUNDCOVERS SHALL BE PLANTED AS DETAILED & AS SHOWN ON THE PLANTING PLAN. ALL BEDS TO RECEIVE A COVER OF CLEAN MULCH TO A DEPTH OF 75mm(3"). FOR GUYING AND STAKING TREES, REFER TO PLANTING DETAILS. WRAP ALL DECIDUOUS TREES UNDER EXPERIENCED SUPERVISION ONLY TO THE SPECIFICATIONS OF THE ONTARIO LANDSCAPE CONTRACTORS ASSOCIATION.

PLANT MATERIAL SIZES AND CONDITIONS ARE TO BE AS INDICATED ON THE LANDSCAPE DRAWING.

THE INDIVIDUAL PLANT GROUPING TOTAL AS ILLUSTRATED ON THE PLANTING PLAN SUPERSEDES THE ESTIMATED QUANTITY ON THE MASTER PLANT LIST. CONTRACTOR MUST REPORT ANY DISCREPANCIES TO THE LANDSCAPE ARCHITECT IN WRITING BEFORE COMMENCING ANY WORK. CONTRACTOR WILL ASSUME FULL RESPONSIBILITY IF LANDSCAPE ARCHITECT IS NOT NOTIFIED OF DISCREPANCIES.

* MULCH - SHREDDED PINE MULCH BY "GRO BARK" OR APPROVED EQUAL. LANDSCAPE ARCHITECT TO APPROVE MULCH BEFORE INSTALLATION.

GENERAL MAINTENANCE

PROPER MAINTENANCE PROCEDURES ARE TO BE FULLY ADMINISTERED FOR ALL NEWLY CONSTRUCTED LANDSCAPE WORK, IN ACCORDANCE WITH LANDSCAPE ONTARIO SPECIFICATIONS (SECTION 1E - MAINTENANCE WORK). THIS SHALL APPLY ONLY DURING THE CONSTRUCTION PERIOD, UNLESS OTHERWISE SPECIFIED. CONTRACTOR IS RESPONSIBLE FOR MAINTENANCE OF SOD AND PLANTING UNTIL FINAL ACCEPTANCE BY LANDSCAPE ARCHITECT.

RODENT PROTECTION

THE CONTRACTOR SHALL BE RESPONSIBLE FOR THE PROTECTION OF ALL TREES AND SHRUBS FOR WINTER PROTECTION AND FROM RODENT INJURY FOR THE DURATION OF GUARANTEE PERIOD. PROTECTIVE GUARDS SHALL BE EMPLOYED AROUND ALL DECIDUOUS TREES. GUARDS TO BE 150MM DIA. PVC PIPE OR AS MUNICIPAL GUIDELINES. GUARDS SHALL BE INSTALLED PRIOR TO THE APPLICATION OF THE MULCH AND SHOULD BE PLACED A MINIMUM OF 50MM (2") OUT FROM THE TREE TRUNK ON ALL SIDES.

ALL SHRUBS AND CONIFEROUS TREES SHALL HAVE AN APPLICATION OF "SKOOF" OR APPROVED EQUIVALENT RODENT FORMULA, TO BE APPLIED AT THE END OF OCTOBER. FOLLOW MANUFACTURER'S DIRECTIONS FOR APPLICATION.

GENERAL REQUIREMENTS

USE ABOVE SPECIFICATIONS IN CONJUNCTION WITH THE GENERAL LANDSCAPE SPECIFICATIONS OF THE ONTARIO LANDSCAPE CONTRACTORS ASSOCIATION, THE NURSERY SOD GROWERS ASSOCIATION OF ONTARIO AND WITH THE GUIDE SPECIFICATIONS FOR NURSERY STOCK OF THE CANADIAN NURSERY TRADES ASSOCIATION. USE ONLY PLANT MATERIAL TRUE TO NAME, SIZE AND GRADE AS SPECIFIED ON PLANTING PLAN. PROVIDE SUFFICIENT LABELS OR MARKINGS TO INDICATE CLEARLY THE VARIETY, SIZE AND GRADE OF EACH SPECIES OR BRAND.

OBTAIN APPROVAL FOR SUBSTITUTIONS AS TO VARIETY, SIZE OR GRADE FROM THE LANDSCAPE ARCHITECT. USE ONLY NURSERY STOCK GROWN UNDER PROPER HORTICULTURAL PRACTICES, VISIBLE, FREE FROM PEST AND DISEASE AND UNDAIMAGED. CHECK LOCATIONS AND OBTAIN STAKEOUTS OF ALL UTILITY LINES BEFORE EXCAVATION. OBTAIN ALL NECESSARY PERMITS BEFORE COMMENCEMENT OF CONSTRUCTION. REPORT IN WRITING ANY DISCREPANCIES IN THE DRAWINGS, SPECIFICATIONS AND CONTRACT DOCUMENTS TO THE LANDSCAPE ARCHITECT BEFORE THE END OF THE BIDDING PROCESS AND COMMENCEMENT OF CONSTRUCTION. THESE SPECIFICATIONS MAY BE SUPERCEDED BY ADDITIONAL SPECIFICATIONS SET OUT IN THE TENDER DOCUMENTS. CONTRACTOR TO REVIEW ALL DOCUMENTS.

GUARANTEE PERIOD

PROVIDE ONE FULL YEAR GUARANTEE ON ALL LANDSCAPE WORK FROM DATE OF FINAL ACCEPTANCE BY LANDSCAPE ARCHITECT. GUARANTEE PERIOD MAY BE EXTENDED TO TWO FULL YEARS DEPENDING ON MUNICIPAL STANDARDS. CONTRACTOR TO VERIFY WITH OWNER AND LANDSCAPE ARCHITECT.

PLANT MATERIAL INSTALLATION

SCALE: N.T.S. DATE: 2 LD-01

REFER TO PLAN FOR LOCATION

WINTER PROTECTION: Shrubs to be wrapped with burlap or approved equal during guarantee period.

PRUNING: (To suit species) Prune to remove damaged or objectionable branches following proper horticultural practice. **DO NOT PRUNE LEADERS.**

GUYING: As directed, appropriate to species and size of shrub

MULCHING: 102 (4") shredded bark mulch by "All Treat" or equal. Provide 102 (4") saucer.

CUT AND REMOVE: burlap from top 1/3 of ball as shown. (B.B. as per plant list)

FERTILIZER: Two (2) 21 gram Agriform tablets or approved equivalent for each shrub in bed.

PLANTING SOIL MIXTURE: (Mix thoroughly)

- For ideal situations mix:
 - 6 parts good quality topsoil
 - 2 parts well rotted cow manure
 - 1 part peat moss
- For clay or wet situations:
 - Contact consultants for proper soil mixture, before proceeding with work
 - Add 0.58 kg (1 lb) of bonemeal per cubic yard of soil
 - Soil mixture should be firmly compacted to eliminate air pockets and prevent settlement.

PREPARATION OF BED: Excavate shrub bed to size outlined on drawings, minimum 457 (18") depth. Remove any subsoil or rubbish off site unless otherwise directed.

SPACING: As directed.

FOR RODENT CONTROL: See landscape specifications or apply "Skooft" at the end of October. Note: All tree stakes, ties and guards are to be removed one year after installation by the landscape contractor.

STANDARD SHRUB PLANTING DETAIL

SCALE: N.T.S. DATE: 3 LD-01

REFER TO PLAN FOR LOCATION

PRUNING: By 1/3 to remove damaged or objectionable branches following proper horticultural practice. **DO NOT PRUNE LEADERS.**

WRAPPING: Approved tree wrap from top of ball to 305 (12") above first branch. Secure with binder twine, wound opposite to wrapping. Secure top, middle and bottom.

GUYING: 1 wo 51 x 51 x 6 (2" x 2" x 1/2") steel T-bars, minimum 2.438 (8'-0") long, and drilled to receive #10 wire threaded through 13 (1/2") Ø rubber hose to support tree. Paint "T" flat black.

WIRE MESH TREE GUARD: For rodent protection

CUT AND REMOVE: burlap from top 1/3 of ball.

MULCHING: 102 (4") shredded bark mulch by "All Treat" or equal.

FERTILIZER: Two (2) 21 gram Agriform tablets for each 25 (1") of trunk diameter (or approved method by Landscape Architect).

GRADES: Maintain original grade of tree base after planting, or slightly higher to suit site conditions.

SLOPES: Build up earth saucer on downhill side. Earth saucer to be compacted.

SCARIFY: edges to allow for root penetration

UNDISTURBED SOIL

PLANTING SOIL MIXTURE: (Mix thoroughly)

- For ideal situations mix:
 - 6 parts good quality topsoil
 - 2 parts well rotted cow manure
 - 1 part peat moss
- For clay or wet situations:
 - Contact consultants for proper soil mixture, before proceeding with work
 - Add 0.58 kg (1 lb) of bonemeal per cubic yard of soil
 - Soil mixture should be firmly compacted to eliminate air pockets and prevent settlement.

NOTE: All tree stakes, ties, wraps and guards are to be removed one year after installation by the landscape contractor.

ALL GIVEN DIMENSIONS ARE IN METRIC

WIRE BASKETS OR STRING ON ROOT BALL - CUT AND TOP REMOVE 1/3

STANDARD DECIDUOUS TREE DETAIL

SCALE: N.T.S. DATE: 4 LD-01

REFER TO PLAN FOR LOCATION

PLANTING SOIL MIXTURE: (Mix thoroughly)

- For ideal situations mix:
 - 6 parts good quality topsoil
 - 2 parts well rotted cow manure
 - 1 part peat moss
- For clay or wet situations:
 - Contact consultants for proper soil mixture, before proceeding with work
 - Add 0.58 kg (1 lb) of bonemeal per cubic yard of soil
 - Soil mixture should be firmly compacted to eliminate air pockets and prevent settlement.

STAKING: Secure three (3) stakes to main tree trunk with approved short hemp rope. Ensure the stakes are not in contact with the bark. Secure into ground with a minimum depth of 350 (1'-6").

MULCHING: Provide 102 (4") shredded bark mulch forming a saucer around base of tree. Maintain the original grade or slightly higher.

CUT AND REMOVE: burlap from top 1/3 of ball.

FERTILIZER: Two (2) 21 gram Agriform tablets for each 25 (1") of trunk diameter (or approved method by Landscape Architect).

GRADES: Maintain original grade of tree base after planting, or slightly higher to suit site conditions.

SCARIFY: edges to allow for root penetration

UNDISTURBED SOIL

NOTE: All tree stakes, ties, wraps and guards are to be removed one year after installation by the landscape contractor.

ALL GIVEN DIMENSIONS ARE IN METRIC

WIRE BASKETS OR STRING ON ROOT BALL - CUT AND TOP REMOVE 1/3

STANDARD CONIFEROUS TREE DETAIL

SCALE: N.T.S. DATE: 5 LD-01

REFER TO PLAN FOR LOCATION

ARMOUR STONE LEDGERROCK - 1100L X 550W X 600HT

INSTALLATION TO BE SUPERVISED BY LANDSCAPE ARCHITECT.

FINISHED GRADE \ PLANT MATERIAL

REFER TO PLANTING SOIL DETAILS

FILTRATION FABRIC - 270R GEOTEXTILE OR APPROVED EQUAL

LEDGE ROCK

FINISHED GRADE \ PAVING

GRANULAR "A" COMPACTED TO 98% S.P.D.

CLEAR GRANULAR 3/4" CRUSH

COMPACTED SUBGRADE (95% S.P.D.)

NOTE: IF STONE WALL/PLANTER EXCEEDS TWO (2) COURSES IN HEIGHT ADD A 150 MM. FABRIC WRAPPED P.V.C. DRAINAGE TILE BEHIND WALL

ALL DIMENSIONS ARE IN MILLIMETRES

LEDGERROCK / ARMORSTONE INSTALLATION DETAIL

SCALE: N.T.S. DATE: 6 LD-01

REFER TO PLAN FOR LOCATION

50x100 (2"x4") P.T. VERTICAL WOOD SUPPORT CENTRED BETWEEN POSTS.

50x100 (2"x4") P.T. WOOD RAIL TOP & BOTTOM

12mm (1/2") GAP BETWEEN FENCE BOARDS.

50x150 (2"x6") P.T. FENCE CAP

150x150 (6"x6") P.T. WOOD POSTS AT 2400 O.C.

25x150 (1"x6") P.T. WOOD SLATS - HORIZONTAL

50x50 (2"x2") P.T. VERTICAL BOARD EA. SIDE OF POST

50x150 (2"x6") P.T. WOOD FENCE CAP

50x100 (2"x4") P.T. TOP & BOTTOM RAIL

25x150 (1"x6") P.T. VERTICAL WOOD SUPPORT FASTENED TO EACH SIDE OF POSTS AND 100x100 (2"x4") P.T. CENTRE PANEL VERT. SUPPORT

150x150 (6"x6") P.T. WOOD POSTS

10mm (3/8") GAP BETWEEN FENCE BOARDS.

25x150 (1"x6") P.T. HORIZ. FENCE BOARDS

50x100 (2"x4") P.T. TOP & BOTTOM RAIL

50x100 (2"x4") P.T. BOTTOM CAP

HEIGHT NOT TO EXCEED LOCAL BY-LAW

SECTION

SECTION

SHOP DRAWINGS FOR POSTS FASTENED ON TOP OF WALL WITH STRUCTURAL ENGINEER APPROVAL TO BE PROVIDED PRIOR TO CONSTRUCTION

FENCE ON CONCRETE WALL CONDITION

POST MOUNTED TO CONCRETE RETAINING WALL (BY OTHERS)

POSTS FASTENED TO CONC. WALL WITH GAL. METAL BRACKETS AS PER ENGINEER APPROVED SHOP DRAWINGS

POURED CONC. RETAINING WALL - OR APPROVED EQUAL - BY OTHERS (REFER TO CIVIL PLAN AND DETAILS FOR MORE INFORMATION)

REFER TO RETAINING WALL (BY OTHERS)

NOTE: MIN. ONE COAT OF OUTDOOR WOOD STAIN (OR AS PER MUNICIPAL REGS.) IS REQUIRED FOR 100% COVERAGE. COLOUR TO BE APPROVED BY OWNER.

NOTES:

- ALL FENCE BOARDS SHALL BE ACQ (ALKALINE COPPER QUATERNARY) OR CA (COPPER AZOLE) PRESSURE TREATED 5-P-F.
- ALL FASTENERS AND METAL COMPONENTS SHALL BE HOT DIPPED GALVANIZED OR CERAMIC COATED FOR EXTERIOR USE AND SHALL BE COMPATIBLE WITH THE ACQ (ALKALINE COPPER QUATERNARY) COMPOUND USED IN PRESSURE TREATMENT SPRUCE.
- FINISH WITH 1 COAT OF APPROVED STAIN, (CLEAR OR COLOUR, AS APPROVED BY OWNER - BEFORE BACKFILLING TO FINISH GRADE)
- INSTALL FENCE ON COMPACTED SUBGRADES AT 95 % S.P.D.
- TOP RAILS & CAP TO BE INSTALLED LEVEL. STEP FENCE SECTIONS AT EQUAL AMOUNTS, I.E. 150, OR 300 MM; TO SUIT FINISH GRADES OF SITE.
- MAINTAIN MINIMUM HEIGHT OF FENCE AS INDICATED.
- ALL MATERIALS, COMPONENTS AND WORKMANSHIP TO CONFORM TO THE ONTARIO BUILDING CODE AND OTHER APPLICABLE LOCAL MUNICIPAL BYLAW.

1800 (6") HT. WOOD PRIVACY FENCE DETAIL

SCALE: N.T.S. 3/8" (10mm) GAP BETWEEN BOARDS 7 LD-01

msla

MARTON SMITH LANDSCAPE ARCHITECTS

170 The Donway W Suite 206
Toronto, Ontario, Canada. M3C 2G3
tel. 416.492.9966 | email. info@msla.ca

Architect:

Client/Owner:

ELITE DEVELOPMENTS

Municipality:

Hamilton

Notes:

05 Issued for Resubmission 11/30/22

04 Issued for Resubmission 11/01/22

03 Issued for Submission 08/24/22

02 Issued for Review 08/10/22

01 Issued for Review 05/21/21

No. Revision Date

North:

Stamp:

Project: **Proposed Stacked Townhouse Development**
487 Shaver Rd.
Ancaster, Ontario

Scale: **As Shown** Date: **Apr 2021**

Drawn By: **C.F.** Checked By: **L.M.**

Drawing Title: **Landscape Details**

Project No. **21101** Sheet No. **LD-01**

All information contained in these plans shall be checked by the contractor. All discrepancies shall be reported to the contractor. All drawings are copyright and shall remain the property of the Landscape Architect. Copying or any reproduction in part or whole that only be permitted with written consent of L.A. A drawing shall not be used for construction unless marked & SIGNED. NOTE: FOR ANY AND ALL GRADING INFORMATION REFER TO SITE GRADING ENGINEERING DRAWINGS. NO SLOPES ARE TO EXCEED 3:1. PROPERTY LINES AND SETBACKS MUST BE CONFORMED BY CONTRACTOR PRIOR TO CONSTRUCTION. ANY AND ALL RETAINING WALLS MUST BE APPROVED BY STRUCTURAL ENGINEER PRIOR TO CONSTRUCTION. * PRELIMINARY NOT FOR CONSTRUCTION UNTIL COUNTERSIGNED BY L.A. ARCHITECT. * SIGNED DATE:

REFER TO PLAN FOR LOCATION

SEE TABLE BELOW FOR HEIGHT AND SPACING
 (NOTE: PANELS MAY BE CUT TO SIZE)

POST SETTING (SEE BELOW)
 NOTE: PANELS MUST BE CUT TO SUIT
 CLEAR BETWEEN PICKETS

POST CAP
 FINISHED GRADE
 CONCRETE FOOTING

PANEL HEIGHT	PANEL WIDTH	POST SETTING (CENTRE TO CENTRE)
914mm (36")	2432mm (96 3/4")	2545mm (101")
1219mm (48")	1898mm (74 3/4")	2032mm (80")
1524mm (60")	1524mm (60")	1524mm (60")
2134mm (84")	1219mm (48")	1219mm (48")
2439mm (96")	914mm (36")	914mm (36")
2744mm (108")	610mm (24")	610mm (24")
3049mm (120")	305mm (12")	305mm (12")

**IRON EAGLE II SERIES
 ELEGANT EAGLE**
 IRON EAGLE INDUSTRIES INC. 1256 CARROLL BLVD. MISSISSAUGA, ONT.
 TEL: 905-470-2200 TOLL-FREE: 800-470-2200

1.2m HT. ORNAMENTAL METAL FENCE - ALUMINUM

SCALE: N.T.S. DATE: _____

REFER TO PLAN FOR LOCATION

50x150 (2"x6") P.T. HORIZ. TONGUE & GROOVE HORIZ. FENCE BOARDS
 30x30 (1"x1") P.T. VERTICAL WOOD TRIM BOTH SIDES
 150x150 (6"x6") AT 2400 G.C. P.T. WOOD POSTS WITH GROOVES FOR FENCE BOARDS
 50x150 (2"x6") P.T. FENCE CAP
 50x150 (2"x6") P.T. HORIZ. TONGUE & GROOVE HORIZ. FENCE BOARDS
 50x150 (2"x6") P.T. WOOD FENCE CAP
 150x150 (6"x6") P.T. WOOD POSTS
 50x150 (2"x6") P.T. HORIZ. TONGUE & GROOVE HORIZ. FENCE BOARDS
 50x100 (2"x4") P.T. BOTTOM RAIL
 50x150 (2"x6") P.T. HORIZ. SKIRT

2300MM
 HEIGHT NOT TO EXCEED LOCAL BY-LAW

1700MM
 4"-1 1/2" MIN.

ON SLAB CONDITION

NOTE: ONE COAT OF OUTDOOR WOOD STAIN IS REQUIRED FOR 100% COVERAGE. COLOUR TO BE APPROVED BY OWNER.

NOTE: 1. USE TOP GRADE CLEAR PRESSURE TREATED LUMBER.
 2. SECURE ALL LUMBER WITH CHARRED COATED SCREWS FOR CEDAR.
 3. FINISH WITH 1 COAT OF APPROVED STAIN, CLEAN OR COLOUR, AS APPROVED BY OWNER - BEFORE BACKFILLING TO FINISH GRADE.
 4. INSTALL FENCE ON COMPACTED SUBGRADE AT 100 MM (4") SP. TOP RAILS & CAP TO BE INSTALLED LEVEL STEP FENCE SECTIONS AT EQUAL INTERVALS, I.E. 1500 OR 3000 MM TO SUIT FINISH GRADES OF SITE.
 5. MAINTAIN MINIMUM HEIGHT OF FENCE AS INDICATED.
 6. ALL MATERIALS, COMPONENTS AND WORKMANSHIP TO CONFORM TO THE ONSHORE BUILDING CODE AND OTHER APPLICABLE LOCAL, MUNICIPAL, BY-LAWS.
 7. FENCE SHALL HAVE A MINIMUM SURFACE DENSITY OF 20 KG/50 M.
 8. FENCE SHALL HAVE A MINIMUM SURFACE DENSITY OF 20 KG/50 M.

2300 HT. WOOD SOUND BARRIER SCREEN

SCALE: N.T.S. HEIGHT NOT TO EXCEED LOCAL BY-LAW

REFER TO PLAN FOR LOCATION

StreetPrint

NOTE: Granular base and sub-base information are minimum requirements. All granular base materials must meet the recommendations of the project soil engineering report for the vehicular use/loads required & to be approved by the geo-technical engineer prior to installation.

STREETPRINT SURFACING SYSTEM THICKNESS AS REQUIRED FOR TRAFFIC LEVELS, COLOR, TYPE OF COATING MATERIAL, AND NUMBER OF LAYERS AS PER SPECIFICATION

STREETPRINT GROUT LINE MIN. DEPTH 1/4" - PATTERN AS PER SPECIFICATION

ASPHALT PAVEMENT THICKNESS AS REQUIRED (50mm MIN. DEPTH AS REQUIRED BY LOCAL CONDITIONS AND TRAFFIC LEVELS TO MATCH EXISTING CONDITION (MIN. 100mm) As per Geotechnical Engineer's calculations & requirements

BASE COMPACTED GRANULAR MATERIAL DEPTH AS REQUIRED BY LOCAL CONDITIONS AND TRAFFIC LEVELS TO MATCH EXISTING CONDITION (MIN. 100mm) As per Geotechnical Engineer's calculations & requirements

EXISTING ASPHALT

SUBGRADE UNDISTURBED SOIL OR THOROUGHLY COMPACTED TO 95% S.P.D.

PLAN

EURO OFFSET BRICK WITH TEXAS COBBLE BORDER

SECTION

NOTES:
 1. INSTALLATION TO BE COMPLETED IN ACCORDANCE WITH MANUFACTURER'S SPECIFICATIONS.
 2. DO NOT SCALE DRAWINGS.
 3. CONFIRM PATTERN AND / OR TEXTURE PRIOR TO INSTALLATION.
 4. CONTACT MANUFACTURER FOR COLOR OPTIONS.
 5. CONTRACTOR'S NOTE: FOR ADDITIONAL PRODUCT INFORMATION REFER TO MANUFACTURER'S SPECIFICATIONS.
 6. DESIGN OF ASPHALT AND GRANULAR BASE TO MEET ENGINEER'S SPECIFICATIONS AND GEOTECHNICAL REQUIREMENTS

IMPRESSED ASPHALT PAVEMENT - BY STREET PRINT

SCALE: N.T.S. INTEGRATED PAVING CONCEPTS, INC.

REFER TO PLAN FOR LOCATION

MAGLIN

MAGLIN SITE FURNITURE INC. 27 BROADHAM PARK DRIVE, ROCKWELL, ONTARIO L4R 1H1
 TEL: 1-877-382-3888 FAX: 1-877-200-0000 www.maglin.com

MATERIALS:
 Bench frame is made from H.S. steel tube and flat bar. The seat and back employ Ipe wood slats, High Density Paper Composite or recycled plastic slats.

FINISH:
 All steel components are protected with E-Coat rust proofing. The Maglin Powercoat System provides a durable finish on all metal surfaces. Wood slats are finished with penetrating sealers.

INSTALLATION:
 The bench is delivered pre-assembled. Holes (Ø.57) are provided in each foot for equispaced tie-downs.

TO SPECIFY:
 Select MLB400 Series
 Choose:
 -Age Recycled Plastic
 -HDPC Powdercoat Colour

SELECT

SELECT POWDERCOAT COLOR:
 FINE TEXTURED COLLECTION
 SILVERH4 - FINETEX
 EVERGREEN - FINETEX
 BLACK - FINETEX
 SUNMETAL - FINETEX
 BRONZEH4 - FINETEX
 SLATE - FINETEX
 TITANIUM - FINETEX
 SCORE TEN - FINETEX

GLOSS COLLECTION
 SILVERH4
 EVERGREEN
 BLACK
 SUNMETAL
 BRONZEH4
 GRAPHITE
 TITANIUM

FRONT VIEW
 SIDE VIEW
 TOP VIEW
 PERSPECTIVE

BENCH BY MAGLIN: MODEL MLB400-R (RECYCLED PLA.)
 BENCH BY MAGLIN: MODEL MLB400W (IPE)

SCALE: N.T.S. DATE: _____

REFER TO PLAN FOR LOCATION

MAGLIN

MAGLIN SITE FURNITURE INC. 27 BROADHAM PARK DRIVE, ROCKWELL, ONTARIO L4R 1H1
 TEL: 1-877-382-3888 FAX: 1-877-200-0000 www.maglin.com

TOP VIEW
 FRONT VIEW
 SIDE VIEW

MATERIALS:
 THE MBR200 BIKE RACK IS CONSTRUCTED USING GALVANIZED H.S. STEEL TUBE AND AN ALUMINUM CASTING. CUSTOM BRASS LETTERING AVAILABLE.

FINISHES:
 THE MBR200 BIKE RACK USES A GALVANIZED POST WITH NATURAL FINISH ON THE ALUMINUM RING CASTING. THE MAGLIN POWDERCOAT SYSTEM FINISH IS ALSO AVAILABLE.

INSTALLATIONS:
 THE MBR200 BIKE RACK IS DELIVERED PRE-ASSEMBLED. IT IS AVAILABLE WITH EITHER A SURFACE MOUNT OR DIRECT BURIAL INSTALLATION OPTION.

BIKE RING
 MBR200

BIKE RACK DETAIL MODEL: MBR200 BY MAGLIN

SCALE: N.T.S. DATE: _____

REFER TO PLAN FOR LOCATION

DESIGN INTENT

DETAILED DESIGN SHOP DRAWINGS WITH STRUCTURAL ENGINEERS APPROVAL TO BE PROVIDED BY OWNER AND APPROVED PRIOR TO CONSTRUCTION

PLAN

ENTRY SIGN ELEVATION

487 Shaver Road

SCALE: N.T.S. DATE: _____

REFER TO PLAN FOR LOCATION

ENTRY SIGN ELEVATION

PLAN

SCALE: N.T.S. DATE: _____

Architect:
 Client/Owner:



Municipality:

Notes:

No.	Revision	Date
05	Issued for Resubmission	11/30/22
04	Issued for Resubmission	11/01/22
03	Issued for Submission	08/24/22
02	Issued for Review	08/10/22
01	Issued for Review	05/21/21

North:

Stamp:

Project:
**Proposed Stacked
 Townhouse Development**
 487 Shaver Rd,
 Ancaster, Ontario

Scale: **As Shown** Date: **Apr 2021**

Drawn By: **C.F.** Checked By: **L.M.**

Drawing Title:
**Landscape
 Details**

Project No. **21101** Sheet No. **LD-02**

All information contained in these plans shall be checked by the contractor. All discrepancies shall be reported to the Landscape Architect (L.A.) before commencing with construction. All drawings have copyright and shall remain the property of the Landscape Architect. Copying or any reproduction in part or whole that only be permitted with written consent of L.A. Drawings shall not be used for construction unless marked & SIGNED.
 NOTE: FOR ANY AND ALL GRADING INFORMATION REFER TO SITE GRADING ENGINEERING DRAWINGS. NO SLOPES ARE TO EXCEED 3:1. PROPERTY LINES AND SETBACKS MUST BE CONFIRMED BY CONTRACTOR PRIOR TO CONSTRUCTION. ANY AND ALL RETAINING WALLS MUST BE APPROVED BY STRUCTURAL ENGINEER PRIOR TO CONSTRUCTION.
 DO NOT SCALE DRAWINGS • PRELIMINARY NOT FOR CONSTRUCTION • THESE DRAWINGS ARE NOT TO BE USED FOR CONSTRUCTION UNTIL COUNTERSIGNED BY L.A. ARCHITECT • SIGNED _____ DATE _____